

# meditrak™ labcapture

## Linking with 'LIMS'

Because of the number of LIMS systems available on the market it may not be possible for *meditrak* to have a direct link. *meditrak* does however, have other ways of capturing data from LIMS.

### Initial Loading

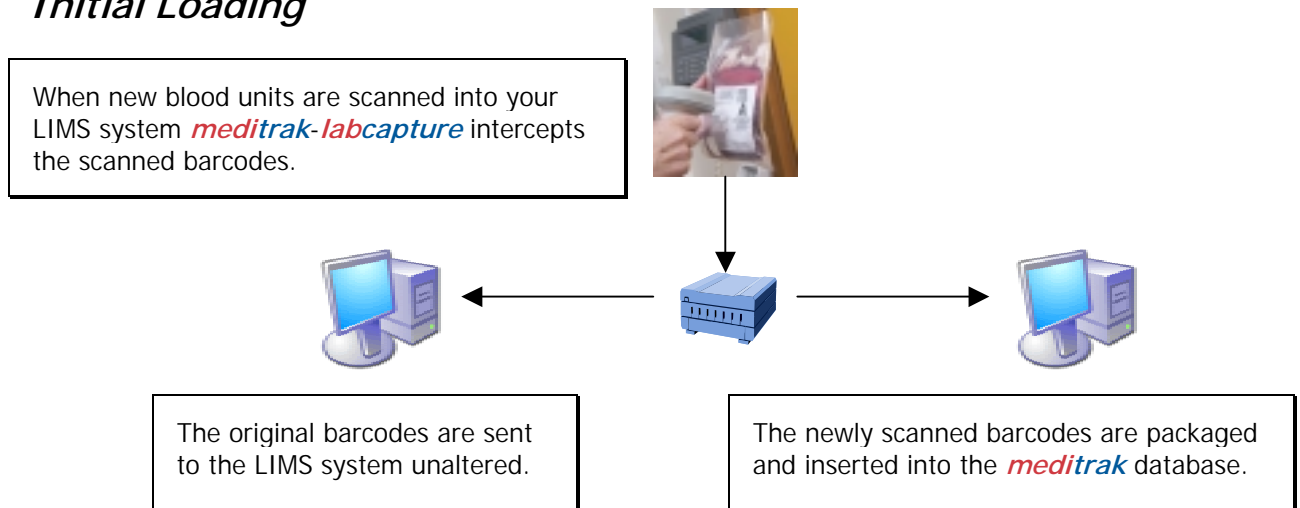

### Patient Cross match

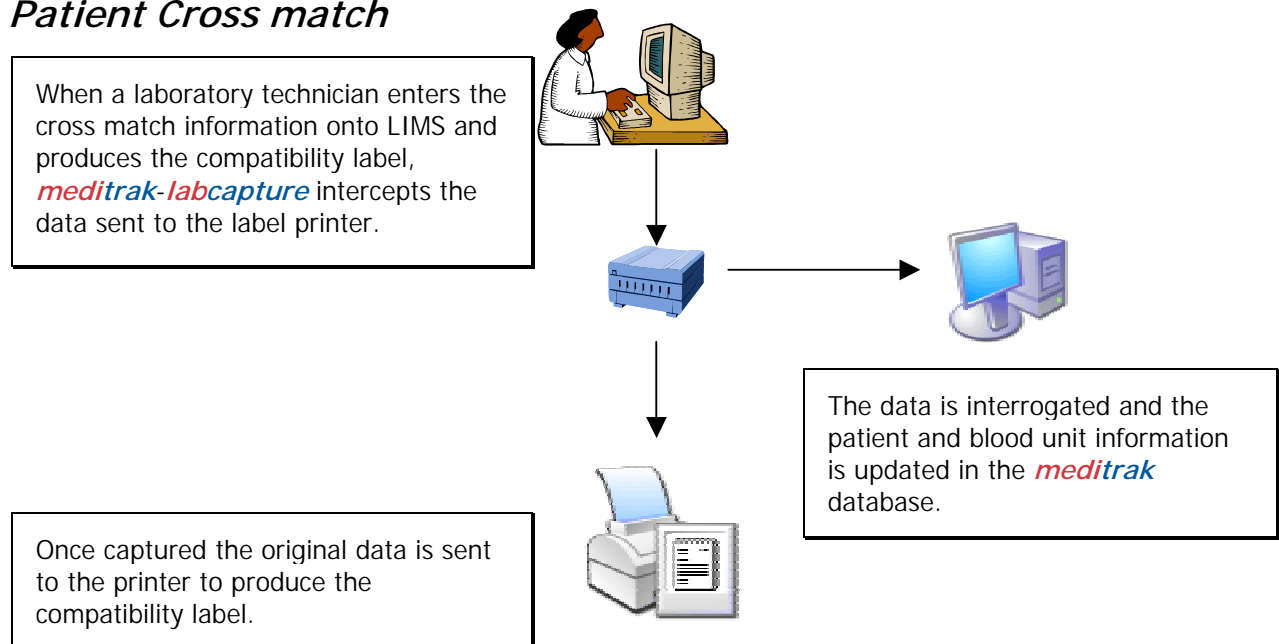



## System Requirements.

### *Initial Load*

#### *RS232 Barcode Scanner*

If your LIMS system uses a 'keyboard wedge' scanner then we can supply a suitable RS232 scanner. The RS232 data is converted back into keyboard codes so there is no change to your LIMS.

#### *Live Network Point*

A live network point is required using IP/TCP protocol.

#### *13A Power Points*

A power point is required to power the network adapter. An additional point may be required to power the RS232 barcode scanner.

### *Patient Cross match*

#### *Label Printer*

To enable *meditrak-labcapture* to capture the information on the compatibility label the LIMS must use a serial text only printer.

#### *Live Network Point*

A live network point is required using IP/TCP protocol.

#### *13A Power Point*

A power point is required to power the network adapter.